

Philco



S
V
C
D
P
H
1
9
0
H
D
M
I

0800 415300

Suporte.tecnico@britania.com.br

Política da Qualidade Britânia

" Oferecer produtos que contribuam para a satisfação de nossos clientes, buscando a melhoria continua de nossos processos "

VISTA EXPLODIDA

PRODUTO	CÓDIGO	PADRÃO N° SÉRIE
DVD PH190	057003010ATX	AA 000.000 V66X
(X) - Último algarismo do código e N° série significam a versão do aparelho		

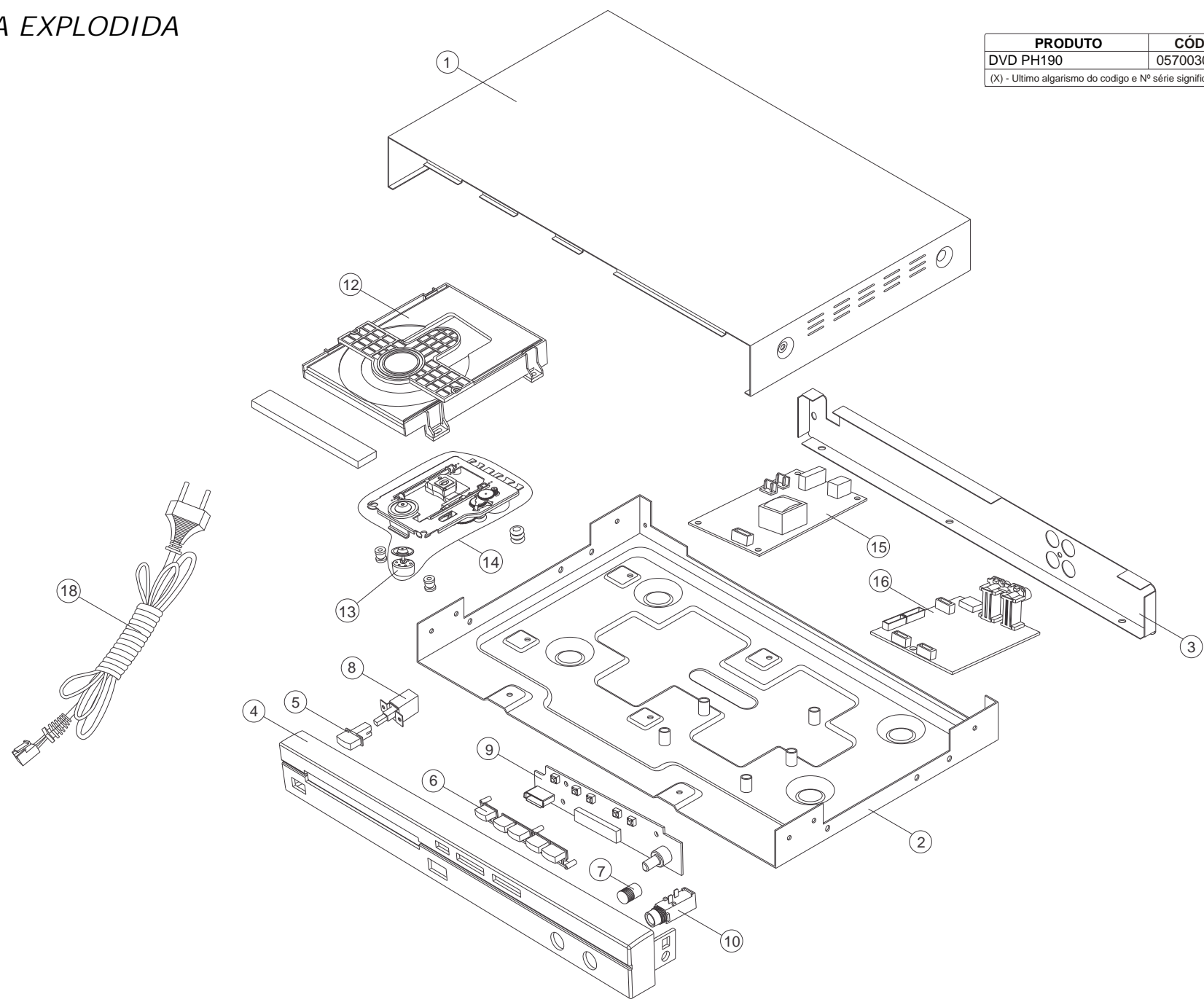

New Parts

ITENS DA VISTA EXPLODIDA

Código	Descrição peça	Nº
707775	GAB SUP DVD PH190	1
707776	GAB INF DVD PH190	2
707774	GAB TRAS DVD PH190	3
707773	GAB FRONT DVD PH190	4
707777	BOTÃO POWER DVD PH190	5
707778	BOTÃO FUNCOES DVD PH190	6
707779	KNOB VOLUME MIC DVD PH190	7
702070	CHAVE MASTER 8A128A, 10A	8
707770	PCI DISPLAY(SMP-N96-C) PH190	9
707410	JACK J10 MIC DVD	10
707771	MEC DVD S/ UNID PH190	12
708930	MOTOR SPINDLE MEC DV34	13
707285	UNID OTICA SOH DL6 MEC DV34	14
704892	UNID OTICA KHM-313AAA	14
705905	PCI FONTE (KT6527A)	15
707371	PCI PRINC (KW-8203RS-P1.1) PH190	16
708839	PCI PRINC (KW-8203RS-P1.1) PH190 V.C	
704986	CORD 2X0,5 1,75M PASSA-FIO 11mm	18

DEMAIS COMPONENTES FORNECIDOS

Código	Descrição peça	Nº
PCI PRINCIPAL		
707769	CI SPHE8203R (SMD)	U4
706076	CI CD5888CB (HSOP28)(SMD)	U5
704478	CI 4558 (SOP-8)(SMD)	U1,U2
700321	TRANSISTOR S8550 (TO-92)(PTH)	
700102	TRANSISTOR B772 BD136(TO-126C)	Q19
PCI FONTE		
707235	CI VIPER22A (DIP-8)(PTH)	U1
701633	CI 817 OPTO (DIP4)(PTH)	U2
701632	CI TL431/KA431 (TO-92)(PTH)	U3
PCI DISPLAY		
706888	CI TM1628 (SOP-28)(SMD)	
ACESSÓRIOS E CABO FLAT		
707772	CABO FLAT 24V 220mm P:0.5 NORMAL	
702088	CABO FLAT 24V 200mm P:0.5 NORMAL	
706815	CABO HDMI 1,5M	
702065	CABO AUDIO E VIDEO 1,15m	
706224	MICROFONE PRETO	
704854	CABO PLUGUE MICROFONE DVD	
706947	CONTROLE REMOTO PHILCO PRETO	
707357	EMBALAGEM SV VCD PH190HDMI	
707780	CONJ CALCO DVD PH190	
707359	MANUAL USUARIO PH190	
707360	GUIA RAPIDO DVD PH190	
705896	CERTIFICADO GARANTIA AUDIO E VIDEO	

NOTA:

- Esta lista está sujeita a alterações sem aviso prévio, consultar o site www.telecontrol.com.br para informações atualizadas.
- Em caso de dúvidas, entrar em contato com o Suporte Técnico
- Somente os itens que possuem códigos serão fornecidos.

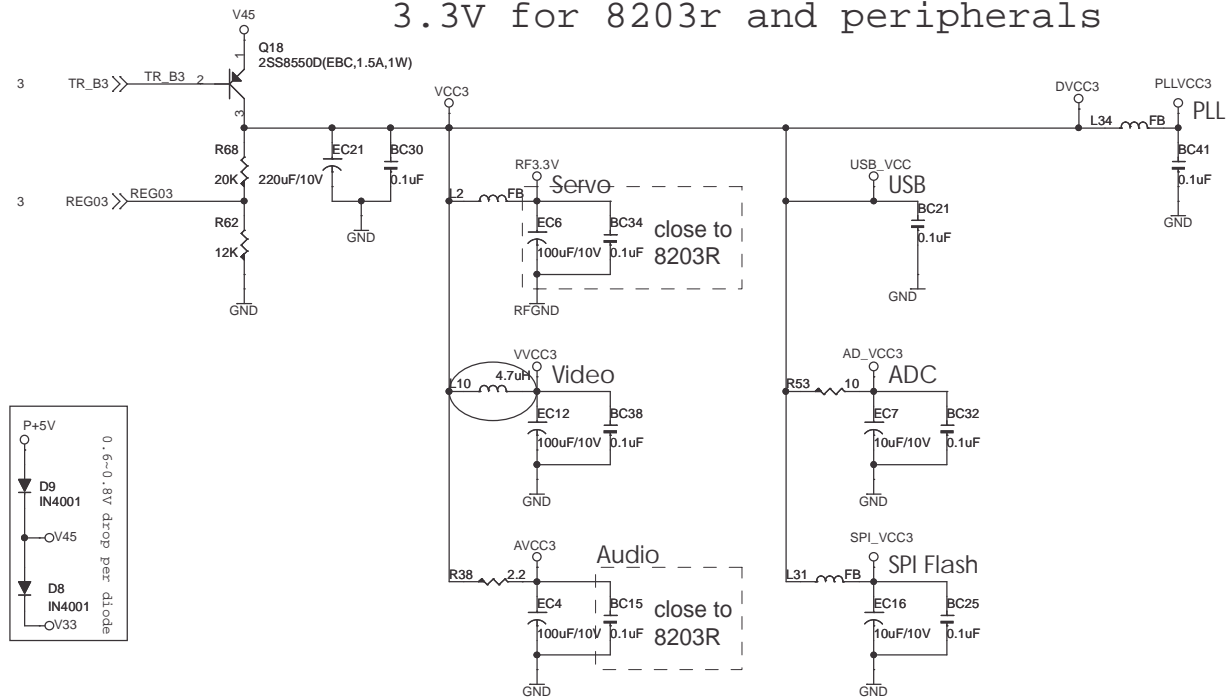

5V for peripherals

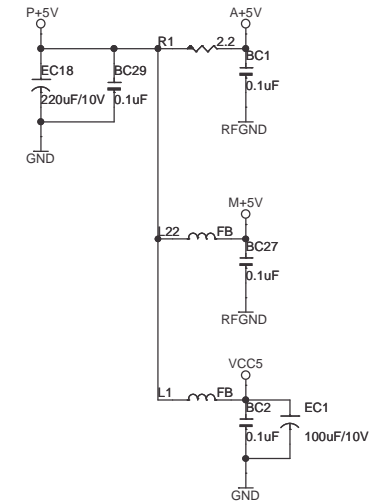

1.25V for core of 8203r

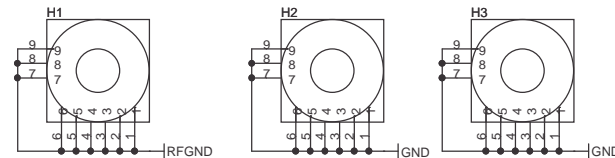
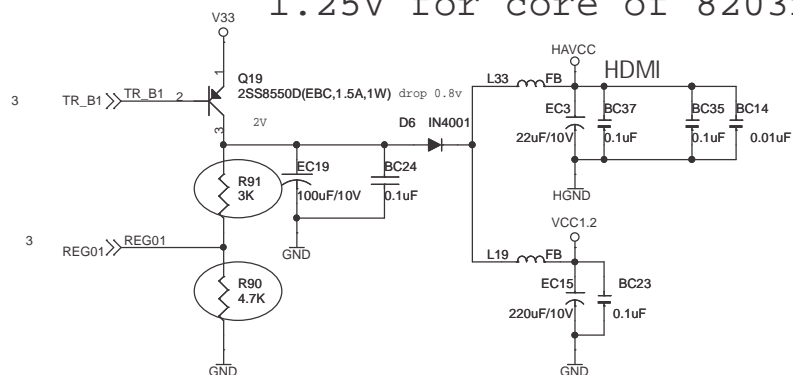

Power Bead > 2A, RAC@100 MHz
= 70 ohm, RDC(max)= 0.4 ohm



CIRCUITO DE ALIMENTAÇÃO PCI PRINCIPAL

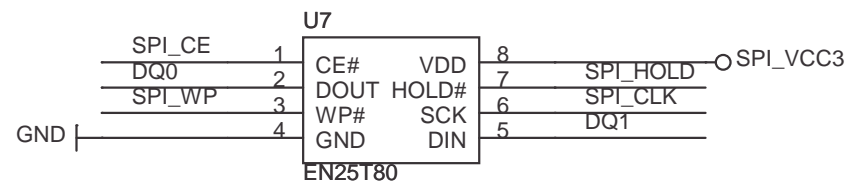

For 1bit SPI Flash



MEMÓRIAS FLASH

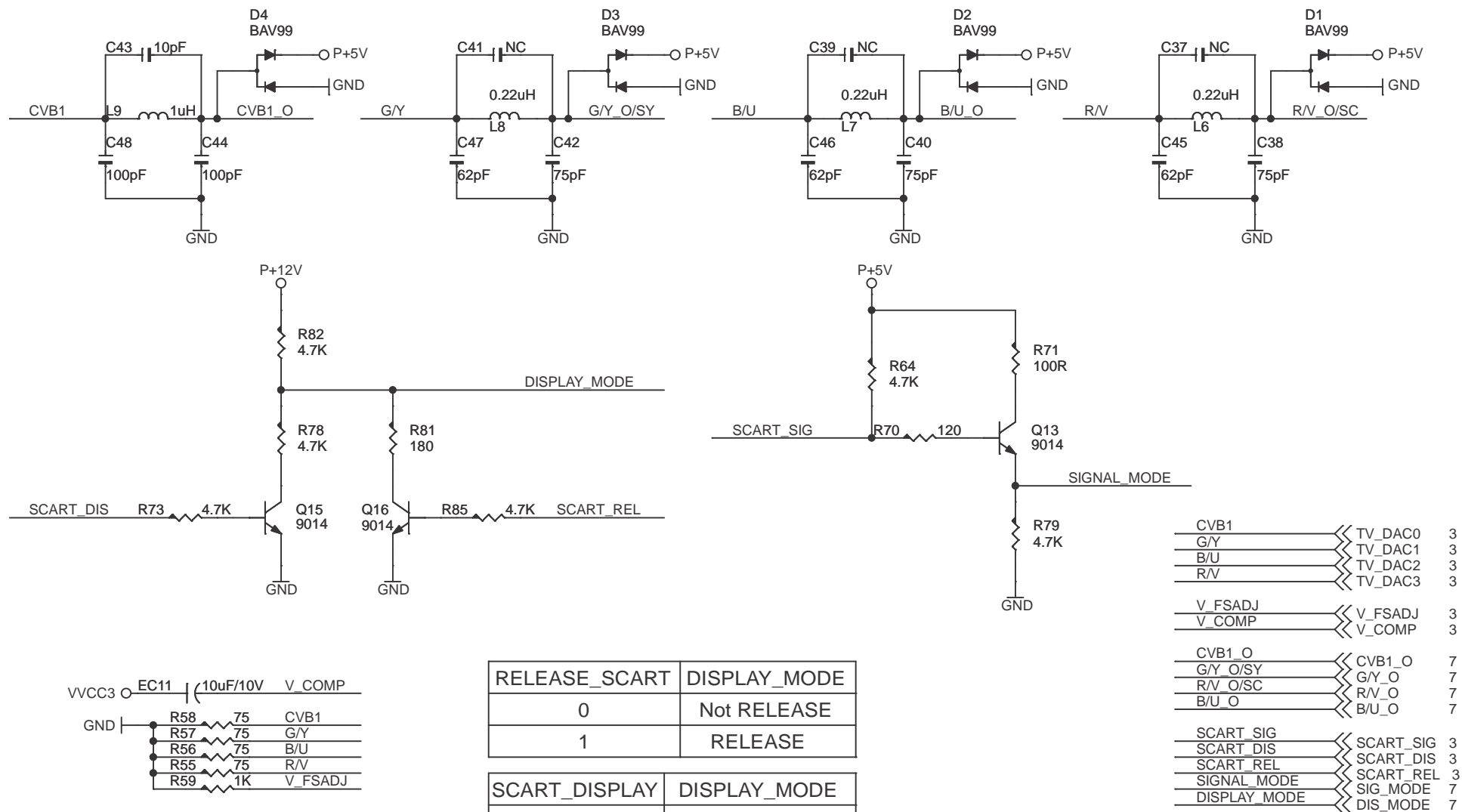

TV0	TV1	TV2	TV3
CVB	Y	Cb	Cr
CVB	Y(S-Video)	CVB	C(S-Video)
CVB	G	B	R

RELEASE_SCART	DISPLAY_MODE
0	Not RELEASE
1	RELEASE

SCART_DISPLAY	DISPLAY_MODE
0	12V(9.5V--12V 4:3)
1	6V(5V--8V 16:9)

SCART_SIG	SIGNAL_MODE
0	0V(CVBS)
1	3V(RGB)

CIRCUITO DE VÍDEO

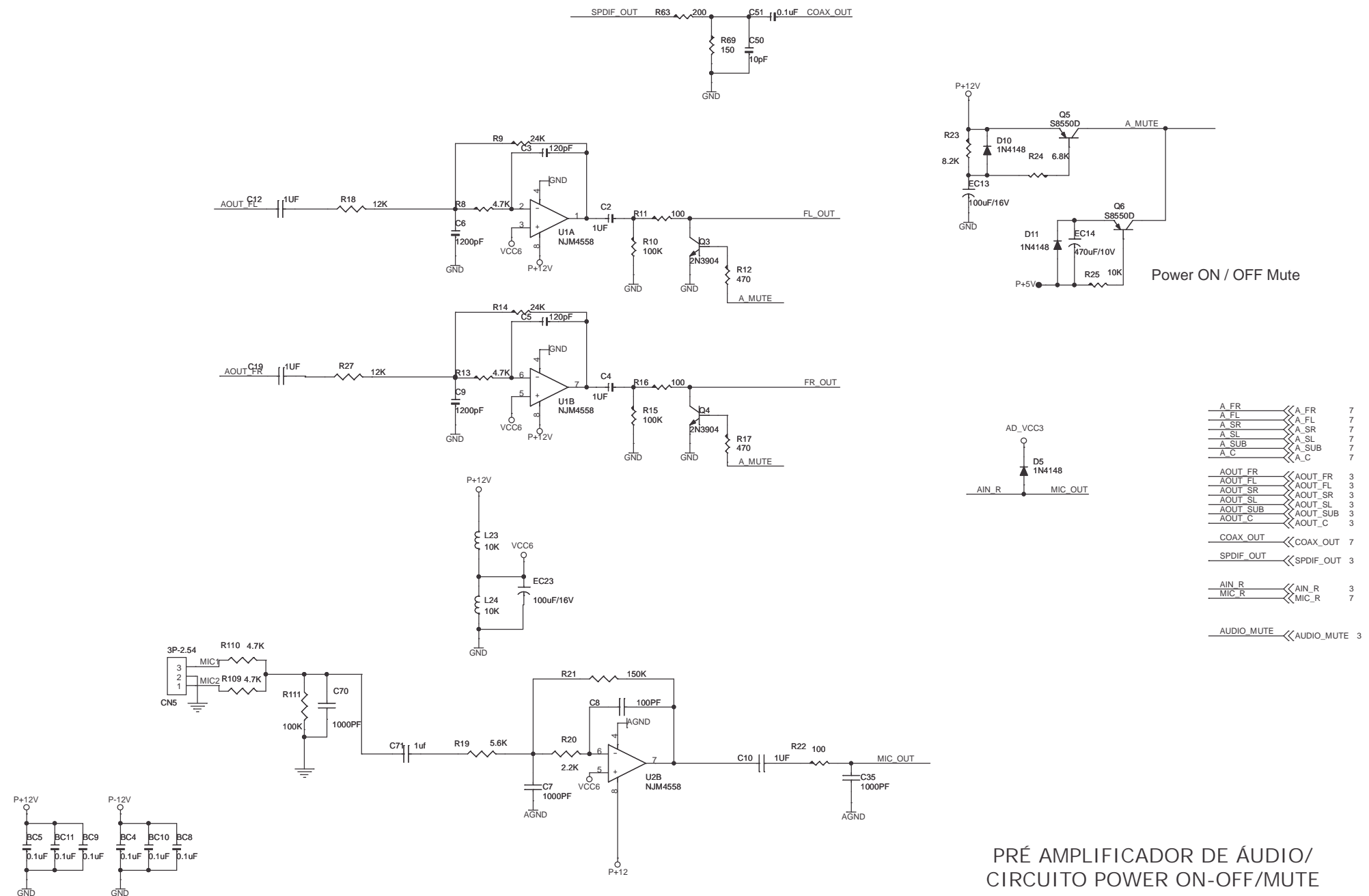

Differential signals (TXC+/-, TX1+/-, TX2+/- and TX3+/-):
50ohm single ended, and 100ohm differential

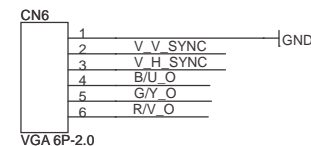
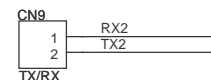
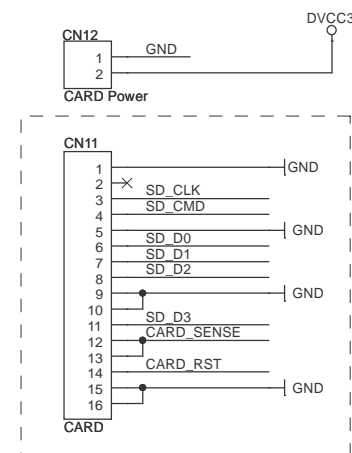
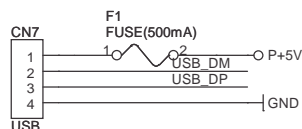
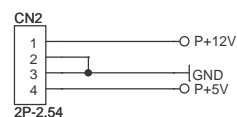
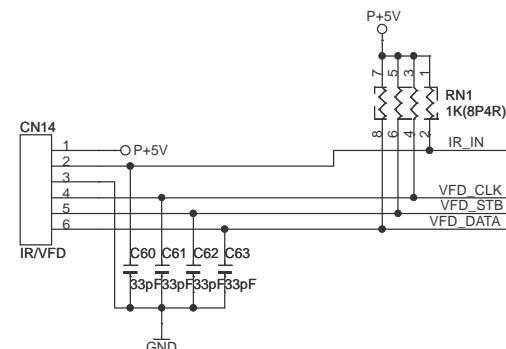
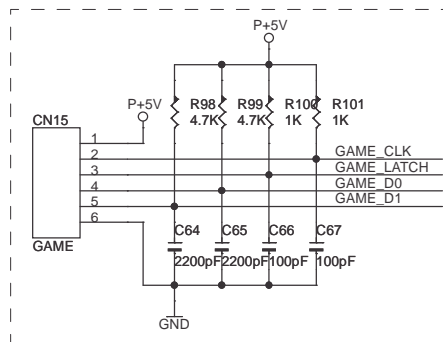
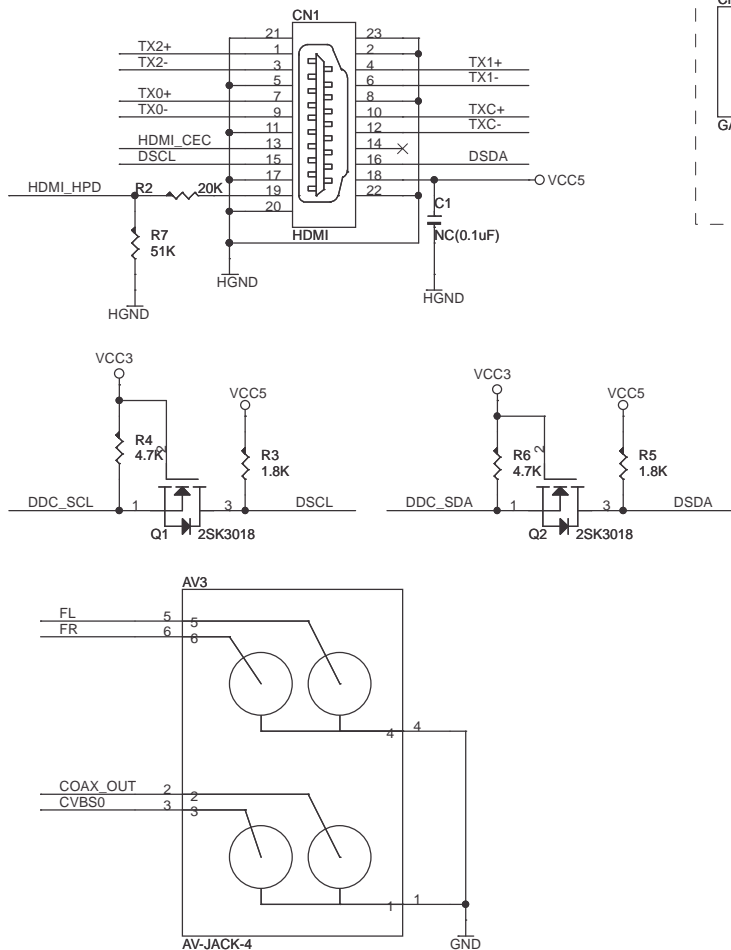

CVB1_O	CVB1_O	5
R/V_O	R/V_O	5
G/Y_O	G/Y_O	5
B/U_O	B/U_O	5
SIGNAL_MODE	SIG_MODE	5
DISPLAY_MODE	DIS_MODE	5
V_V_SYNC	V_V_SYNC	3
V_H_SYNC	V_H_SYNC	3
RX2	RX2	3
TX2	TX2	3

A_FR	A_FR	6
A_FL	A_FL	6
A_SR	A_SR	6
A_SL	A_SL	6
A_SUB	A_SUB	6
A_C	A_C	6
COAX_OUT	COAX_OUT	6

IR_IN	IR_IN	3
VFD_CLK	VFD_CLK	3
VFD_STB	VFD_STB	3
VFD_DATA	VFD_DATA	3

USB_DM	3
USB_DP	3

SD_CLK	SD_CLK	3
SD_CMD	SD_CMD	3
SD_D0	SD_D0	3
SD_D1	SD_D1	3
SD_D2	SD_D2	3
SD_D3	SD_D3	3
CARD_SENSE	CARD_SENSE	3
CARD_RST	CARD_RST	3

```

GAME_CLK      <-- GAME_CLK  3
GAME_LATCH    <-- GAME_LATCH
GAME_D0       <-- GAME_D0   3
GAME_D1       <-- GAME_D1   3

```

TXC+	TXC+	3
TXC-	TXC-	3
TX0+	TX0+	3
TX0-	TX0-	3
TX1+	TX1+	3
TX1-	TX1-	3
TX2+	TX2+	3
TX2-	TX2-	3
DDC_SCL	DDC_SCL	3
DDC_SDA	DDC_SDA	3
HDMI_HPD	HDMI_HPD	3
HDMI_CEC	HDMI_CEC	3

CONECTORE SAÍDA DE ÁUDIO E VÍDEO/ HDMI/USB/CARD/GAME

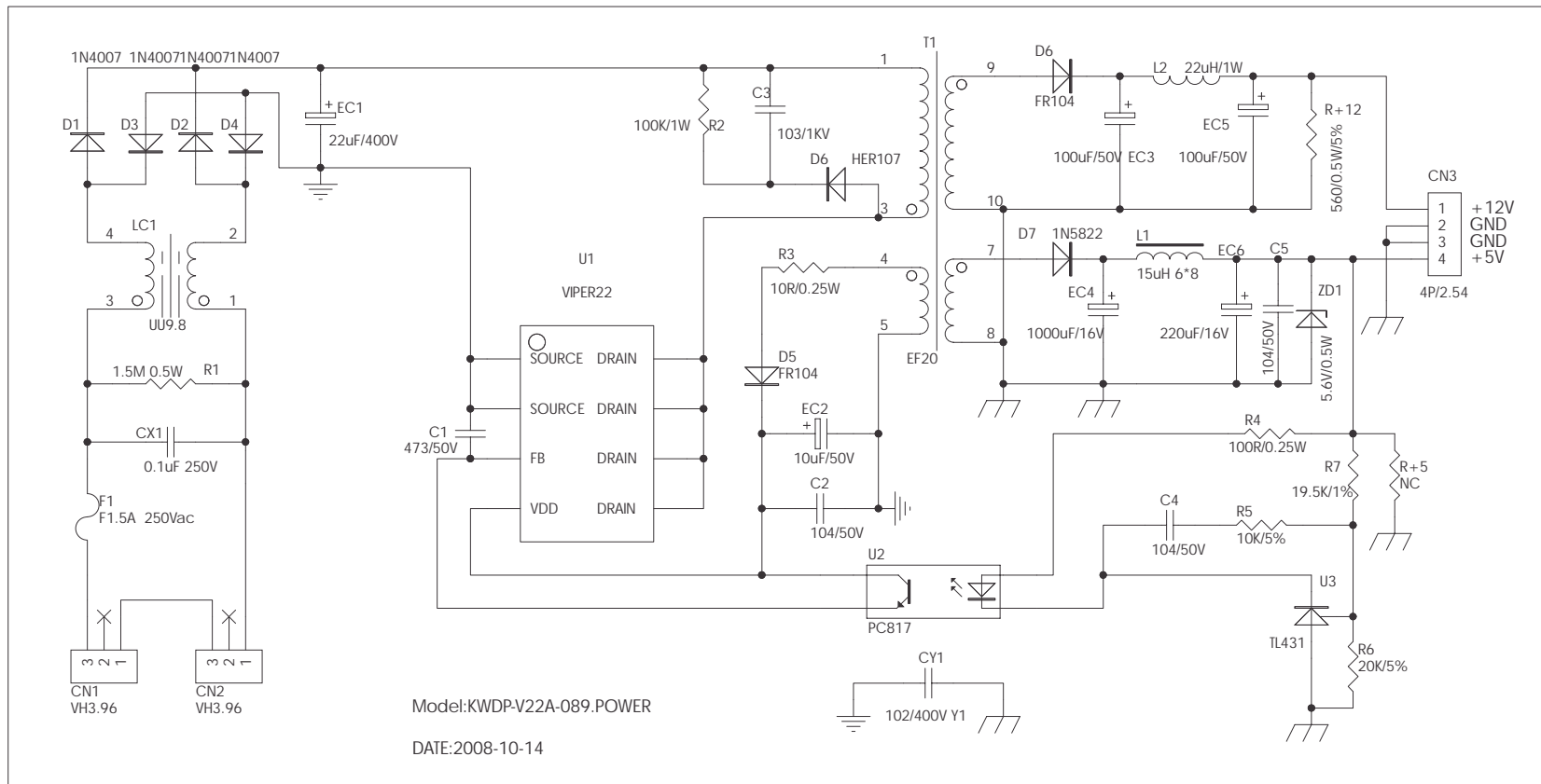

FONTE